

BUE: Flanged three-way valves, PN 16/10

How energy efficiency is improved

Accurate control with high reliability.

Areas of application

Continuous control of cold/hot water, air and low-pressure steam up to 115°C in closed networks¹⁾. Water quality as per VDI 2035. Assembly with AVP 242 to AVP 244 actuators as a regulating unit.

Features

- Nominal pressure 16 bar
- Control valve contains no silicone grease; painted black
- Nominal diameters DN15 to DN150
- Equal-percentage characteristic in the case of F300
- Linear characteristic in the case of F200 with increased k_{vs} value
- Linear mixing passage characteristic
- With the spindle retracted, the valve is closed
- Application as control valve or diverting valve

Technical description

- Valve with flange connection as per EN 1092-2, Form B, raised face, for PN16 and PN10
- Valve body and seat in cast iron
- Stainless steel spindle
- Brass plug in nominal diameters DN15 to DN50, with glass-fibre-reinforced PTFE sealing ring
- Brass plug in nominal diameters DN65 to DN150, metal-on-metal seal
- Stuffing box made of brass with EPDM wiper ring and double O-ring seal



T10988



Y07545

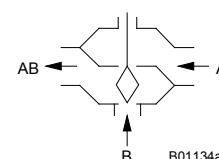

B01134a

Type	Nominal diameter DN	Connection PN	k_{vs} value m³/h	Weight kg
BUE 015 F330	15	16 / 10	1.0	3.2
BUE 015 F320	15	16 / 10	1.6	3.2
BUE 015 F310	15	16 / 10	2.5	3.2
BUE 015 F300	15	16 / 10	4.0	3.2
BUE 020 F300	20	16 / 10	6.3	4.1
BUE 025 F300	25	16 / 10	10	4.7
BUE 032 F300	32	16 / 10	16	7.1
BUE 040 F300	40	16 / 10	22	8.4
BUE 050 F300	50	16 / 10	28	11.2
BUE 050 F200	50	16 / 10	40	11.2
BUE 065 F300	65	16 / 10	49	17.3
BUE 065 F200	65	16 / 10	63	17.3
BUE 080 F300	80	16 / 10	78	22.9
BUE 080 F200	80	16 / 10	100	22.9
BUE 100 F300	100	16 / 10	124	33.0
BUE 100 F200	100	16 / 10	160	33.0
BUE 125 F300	125	16 / 10	200	48.0
BUE 125 F200	125	16 / 10	240	48.0
BUE 150 F300	150	16 / 10	300	68.0
BUE 150 F200	150	16 / 10	320	68.0

Operating temperature	-10...150 °C ²⁾	Dimension drawing	DN 15...50	M10437
Operating pressure	up to 120 °C, 16 bar up to 130 °C, 13 bar up to 150 °C, 10 bar		DN 65...150	M10441
Valve characteristic for control passage	F200 linear F300 equal-percentage	Fitting instructions	Valve	DN 15...50 MV 506008
mixing passage	linear		Valve	DN 65...150 MV 505964
Valve control ratio	> 50:1		Assembly	AVP 242 F001 MV 506041
Stuffing box	2 O-rings. EPDM		Assembly	AVP 242 F021 MV 506012
Leakage rate at max. Δps control passage	≤ 0.05% of k_{vs} value		Assembly	AVP 243 / 244 MV 506013
mixing passage	≤ 1% of k_{vs} value			
Stroke DN 15...50	8 mm	Material declaration		MD 76.116
DN 65...80	20 mm			
DN 100...150	40 mm			

¹⁾ Air humidity must not exceed 75%

²⁾ At temperatures below 0°C, use the stuffing box heater; at temperatures above 100°C, use the temperature adaptor (accessory).

Accessories

- 0372240 001*** Manual adjuster for valves with 8 mm stroke; MV 505813
- 0372249 001*** Adaptor required when temperature of medium >100 °C up to 130 °C (recommended at temperatures of < 10 °C) from DN 15 to DN 50, MV 505932
- 0372249 002*** Adaptor required when temperature of medium >130 °C up to 150 °C , from DN 15 to DN 50, MV 505932
- 0372336 180** Adaptor required when temperature of medium. >130 °C / >150 °C from DN 65, MV 505902
- 0378284 100*** Stuffing box heater, 230 V~; 15 W, for media below 0°C, DN 15...150, MV 505978
- 0378284 102*** Stuffing box heater, 24 V~; 15 W, for media below 0°C, DN 15...150, MV 505978
- 0378368 001** Complete replacement stuffing box for DN 15 to DN 50
- 0378369 001** Complete replacement stuffing box for DN 65 to DN 150

*) Dimension drawing or wiring diagram available under the same number

Warranty	The technical data and pressure differences indicated here are only applicable in combination with Sauter actuators. Any warranty shall lapse if actuators from other manufacturers are used.
----------	---

Combination of BUE, PN 16/10 with pneumatic drive AVP 242

Drive	AVP 242 F001		
Perm. press. p_{stat}	≤ 10 bar		
Running time ¹⁾	8 s		
Stroke	8 mm		
Valve	Δp_{max}	Δp_s	
BUE 015	10.0	16.0	
BUE 020	10.0	16.0	
BUE 025	10.0	12.0	
BUE 032	6.0	6.5	
BUE 040	4.0	4.0	
BUE 050	2.5	2.5	

For temperatures above 100 °C, accessories are required

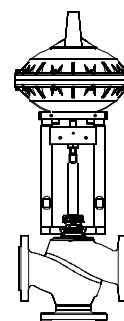

B10680

Drive	AVP 242 F021		
Perm. press. p_{stat}	≤ 10 bar		
Running time ¹⁾	8 s		
Stroke	20 mm		
Valve	Δp_{max}	Δp_s	
BUE 065	1.2	1.5	
BUE 080	0.8	1.0	

For temperatures above 130 °C, accessories are required

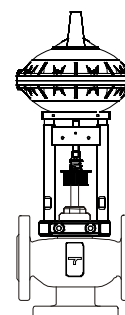

B10681

Combination of BUE, PN 16/10 with pneumatic drive AVP 243 / 244

Drive	AVP 243 F021			AVP 244 F021		
Perm. press. p_{stat}	≤ 10 bar			≤ 10 bar		
Running time ¹⁾	24 s			40 s		
Stroke	20 mm			20 mm		
Valve	Δp_{max}	Δp_s		Δp_{max}	Δp_s	
BUE 065	2.0	2.3		3.0	4.5	
BUE 080	1.3	1.5		3.0	3.0	

For temperatures above 130 °C, accessories are required

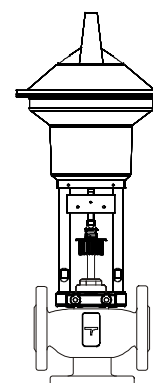

B10682

Drive	AVP 243 F031			AVP 244 F031		
Perm. press. p_{stat}	≤ 10 bar			≤ 10 bar		
Running time ¹⁾	24 s			40 s		
Stroke	40 mm			40 mm		
Valve	Δp_{max}	Δp_s		Δp_{max}	Δp_s	
BUE 100	1.0	1.0		2.0	2.0	
BUE 125	0.6	0.6		1.2	1.2	
BUE 150	0.4	0.4		1.0	1.0	

For temperatures above 130 °C, accessories are required

¹⁾ In relation to the Centair air rate (400 l_n/h) and to a pipe with length of 20 m and diameter of 4 mm

Valve: Variant F, for technical data and accessories see Valve Type Table

Drive: Variant F, for technical data, accessories and installation position see section 71

Example: BUE 065 F300 / AVP 243 F031

Valve control passage A-AB is closed when actuator is pressureless = factory setting

Valve control passage A-AB is open when actuator is pressureless = on request

 Δp_{max} [bar]= Maximum permitted pressure difference across the valve at which the drive can still reliably open and close the valve, taking account of Δp_v . Δp_s [bar]= Maximum permitted pressure difference across the valve in case of a fault (pipe break downstream of the valve) at which the drive can close the valve reliably with 'fast' performance of the stroke.

Pressure-stroke characteristic (with valve fitted)
Characteristic is not adjustable:

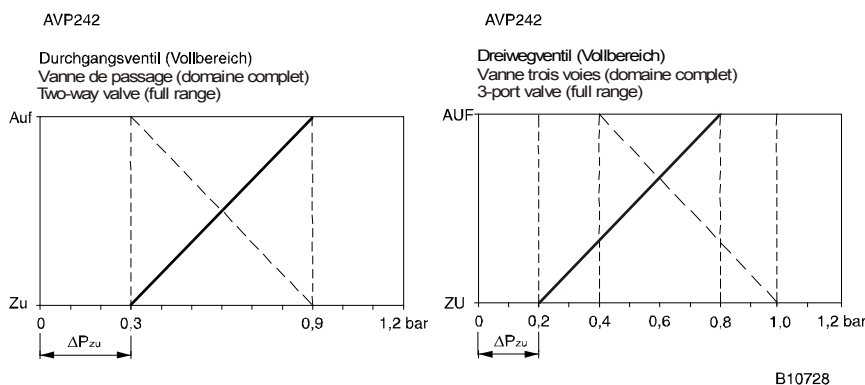

Characteristic is adjustable:

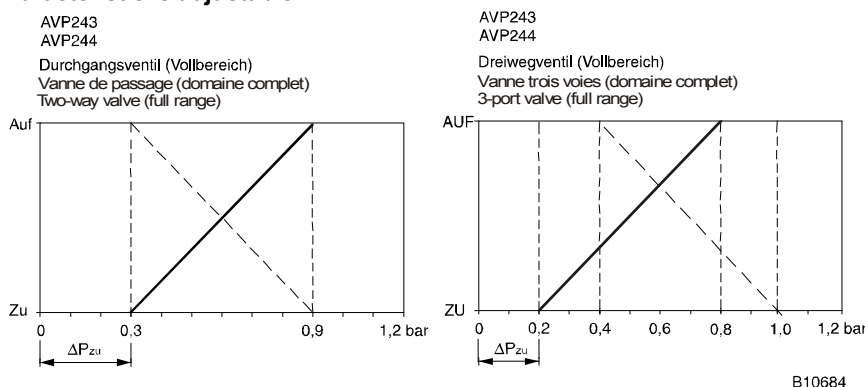

———— = CLOSED without pressure (function E)
- - - - - = OPEN without pressure (function A)

Sequences with XSP31 are possible

The valve can be moved to any intermediate position by means of a pneumatic drive. If the valve stem is extended, the control passage of the valve is closed. The valves must be used only as a 'control valve'. The direction of flow marked on the valve must be observed. Usage as a diverting valve is not permissible with pneumatic drives, since it would cause pressure surges. The fluidic parameters comply with EN 60534.

Used as a control valve

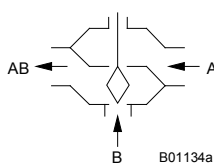

Description

The key features of these control valves are their high reliability and precision, and they make a major contribution towards environment-friendly control. They meet demanding requirements including safety functions, coping with differential pressures, controlling the medium temperature and providing a shut-off function; all this is achieved with a low noise level.

An automatic and fixed connection is made between the valve stem and the drive shaft. The plug (which is made of brass) controls an equal-percentage flow in the control passage. The tightness of this valve is guaranteed by the seat which is machined in the body.

The stuffing box is maintenance-free; it consists of a brass body, 2 O-rings and a grease reserve. This is free of silicone grease and no silicone oil must be used for the stem. The grease reserve prevents particles that might be present in the medium from reaching the upper O-ring.

Engineering and fitting notes

The drive is placed directly on top of the valve and is fixed with screws. The connection between the drive and the valve stem is made automatically. The closing point must be set as described in the installation instructions (MV 506012 AVP 242 or MV 506013 AVP 243/244).

Installation position

The final control element can be installed in any position, except facing downwards. Condensate and water drips etc. must be prevented from penetrating into the drive. With a horizontal installed position and in relation to the valve stem, the permitted maximum drive (or other) weight is 25 kg unless a support is provided by the customer or others.

When fitting the drive onto the valve, you must make sure that the plug is not rotated on the seat (this would damage the sealing surface). If the valve is insulated, the insulation must only extend as far as the connecting clip of the drive.

Applications with steam

The valves may be used for low-pressure steam up to 115 °C with the same Δp_{\max} values, but we advise you only to use the valves for open-closed switching. For use as a control valve, you should make sure that the majority of the work is not done in the lower third of the valve stroke range. In this case, an extremely high flow speed would develop, severely reducing valve's lifetime.

Applications with water

To ensure that impurities in the water (such as welding beads or particles of rust, etc.) are retained and the plug seal is not damaged, it is advisable to install collective filters, e.g. for each storey or pipe run. Water quality requirements conform to VDI 2035. If an additional medium is used, the compatibility of the materials must be clarified with the manufacturer of the medium. The Material Table shown below can be used for this purpose. If glycol is used, we recommend that a concentration of between 20% and 55% should be selected.

The valves are not suitable for drinking water or in zones where there is a risk of explosions.

Other notes concerning hydraulics and noises in systems

The valves can be used in a low-noise environment. To avoid noises, the pressure differences Δp_{\max} listed below should not be exceeded.

Pressure difference Δp_v is the maximum pressure that may be present on the valve, regardless of the stroke position, so that the danger of cavitation and erosion is limited. These values are independent of the drive force. Cavitation accelerates wear on the plug and the seat in the valve, and causes noises. To prevent cavitation, differential pressure Δp_{\max} should not exceed value Δp_{krit} :

$$\Delta p_{\text{krit}} = (p_1 - p_v) \times 0,5$$

p_1 = upstream pressure in front of the valve (bar) p_v = steam/vapour pressure

Absolute pressure is used for the calculations.

The close/off pressure values which are also listed represent the maximum pressures at which the drive can still use its own force to move the valve. It should be pointed out here that if these pressures are used and the pressure difference Δp_{\max} is exceeded, the valve may sustain damage due to cavitation and erosion. In case of a spring return function, the stated Δp_s values also represent the permitted differential pressure up to which the drive guarantees closure of the valve in case of an incident. As this is an emergency function with 'fast' passage through the stroke (by means of the spring), this value may exceed Δp_{\max} .

Pressure loss table

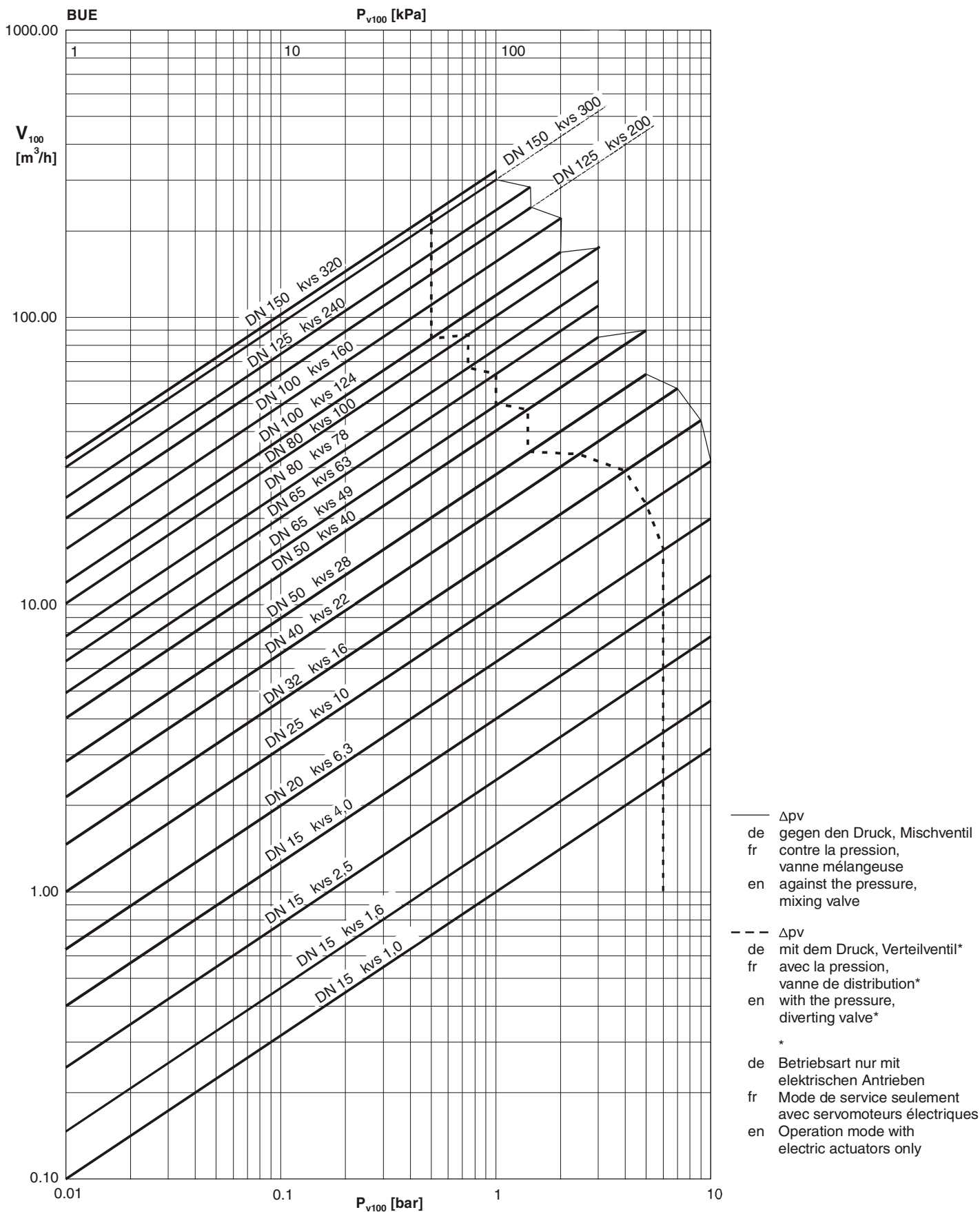

Type	Δp_v used as a control valve
BUE 015 F330	10
BUE 015 F320	10
BUE 015 F310	10
BUE 015 F300	10
BUE 020 F300	10
BUE 025 F300	10
BUE 032 F300	9
BUE 040 F300	7
BUE 050 F300	5
BUE 050 F200	5
BUE 065 F300	3
BUE 080 F300	3
BUE 100 F300	2
BUE 125 F300	1,5
BUE 150 F300	1,0

Additional technical data

- ☐ Pressure and temperature data
☐ Parameters related to flow mechanics
☐ Sauter slide rule for valve sizing
☐ Manual for slide rule
☐ Technical manual: 'Regulating Units'
☐ Parameters, installation notes, control, general

EN 764, EN 1333
 VDI/VDE 2173
 7 090011 001
 7 000129 001
 7 000477 001
 Valid EN, DIN, AD,
 TRD and UVV
 specifications
 /regulations
 97/23/EC
 Article 33
 Category I

- ☐ CE conformity, Pressure Equipment Directive (fluid group II)
☐ BUE 015 to BUE 050: no CE symbol
☐ BUE 065 to BUE 150 CE symbol

Additional information

Valve body made of grey cast iron to EN 1563, code EN-GJL-250, material number EN-JL 1040 with smooth drilled flanges to EN 1092-2, form B, sealing strip. Valve body to RAL 9005, dark black. Recommendation for welding-neck flange as per EN 1092-2. Overall valve length to EN 558-1, basic series 1. Flat seal on valve body made of asbestos-free material.

DIN material numbers

	DIN material numbers	DIN material designation
Valve body	EN-JL 1040	EN-GJL-250 (GG25)
Valve seat	EN-JL 1040	EN-GJL-250
Stem	1.4305	X 8 Cr Ni S 18-9
Plug	CW 617 W	CuZn40Pb2
Plug seal	PTFE	
Stuffing box	CW 617 W	CuZn40Pb2
Valve body	EN-JL 1040	EN-GJL-250 (GG25)

Detailed information on pressure difference definitions

Δp_v :
 Maximum permissible pressure difference across the valve in any stroke position, limited by the noise level and erosion.
 The valve as a traversed element is defined by this parameter specifically in its hydraulic behaviour. By monitoring cavitation, erosion and the noise thus produced, improvements can be achieved in both life expectancy and durability.

Δp_{max} :
 Maximum permissible pressure difference across the valve at which the drive can firmly open and close the valve.
 Static pressure and fluidic influences are taken into account. This value helps to maintain smooth stroke action and valve sealing. In doing so, the valve's Δp_v value is not exceeded.

Δp_s :
 Maximum permissible pressure difference across the valve in the event of a malfunction (e.g. power failure) at which the drive can firmly close the valve and, if necessary, hold the full operating pressure against atmospheric pressure. Since this is a safety function with 'fast' stroke, Δp_s can be larger than Δp_{max} or, respectively, Δp_v . The resultant fluidic disturbances are soon overcome and play a minor role here.
 On the three-way valves, the values apply only for the control passage.

Δp_{stat} :
 Line pressure across the valve. This corresponds largely to the dead pressure when the pump is switched off, e.g. due to the level of liquid in the plant, an increase in pressure via the pressure store, steam pressure etc.
 On valves that close with the pressure, the static pressure plus the pump pressure should be used.

Dimension drawings

DN 15...50

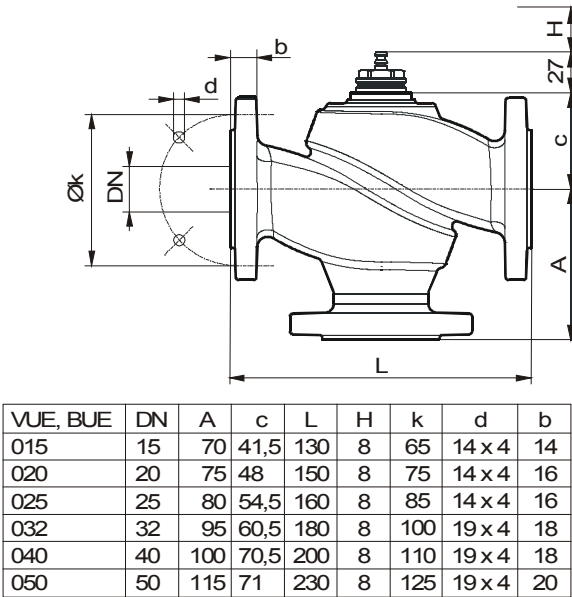

DN65...150

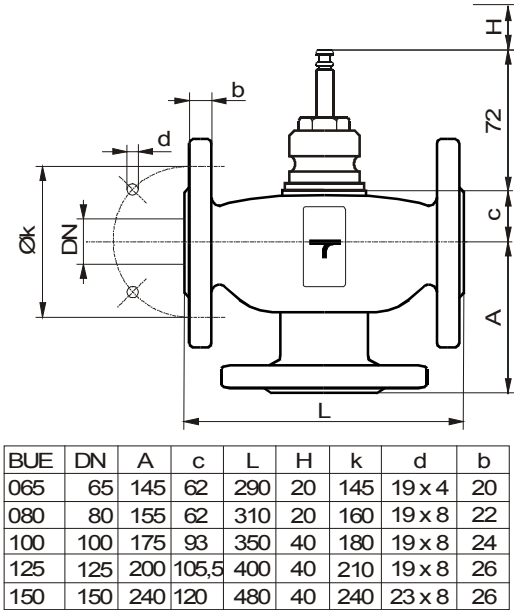

AVP 242 F001

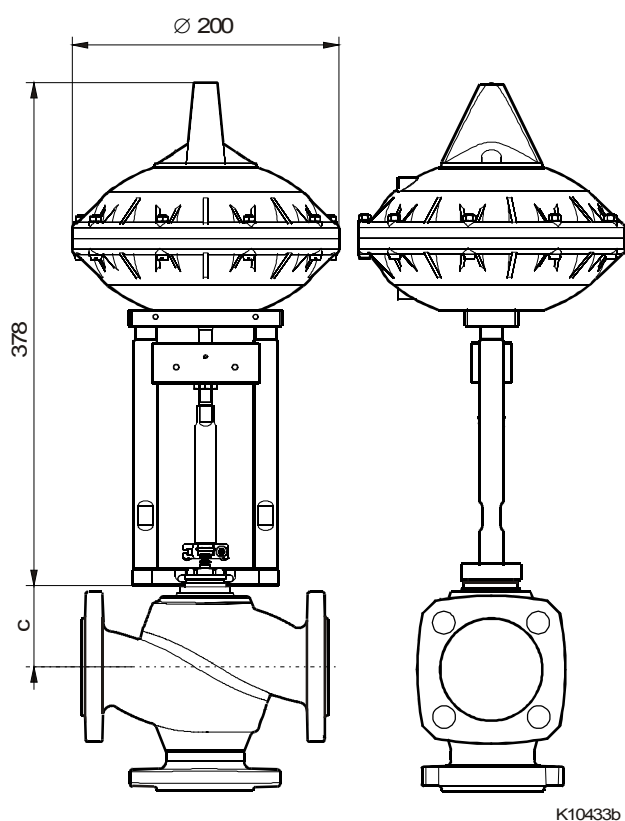

AVP 242 F021

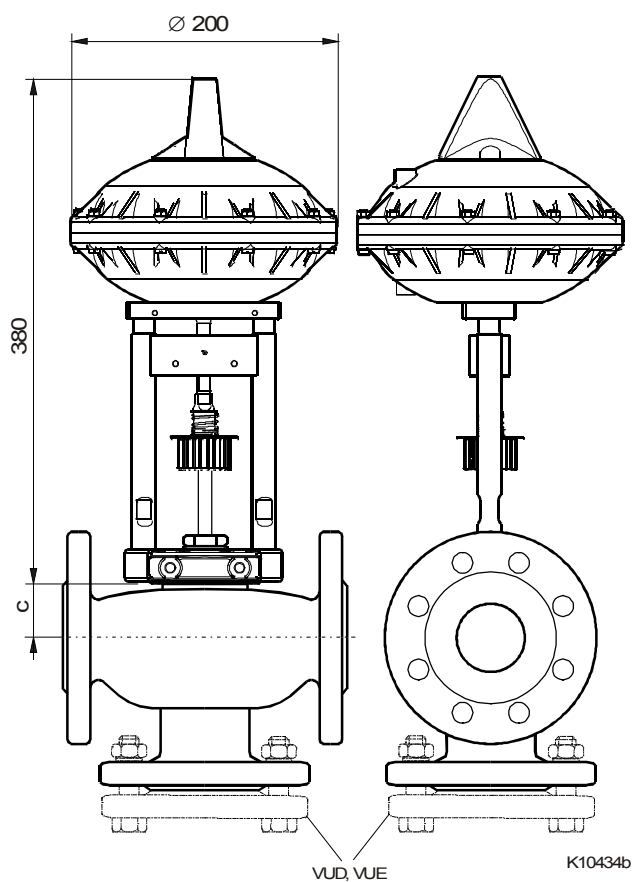

AVP 243/244

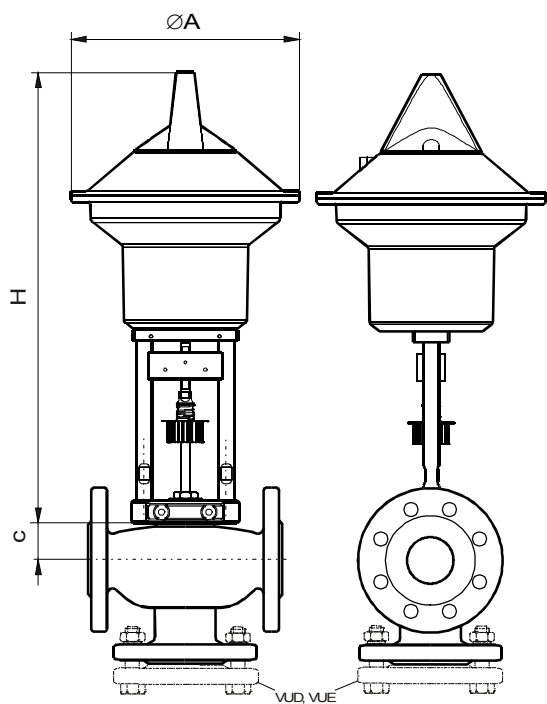

AVP ...	A	H
243 F021	250	497
243 F031	250	517
244 F021	335	536
244 F031	335	556

K10435a

Accessories

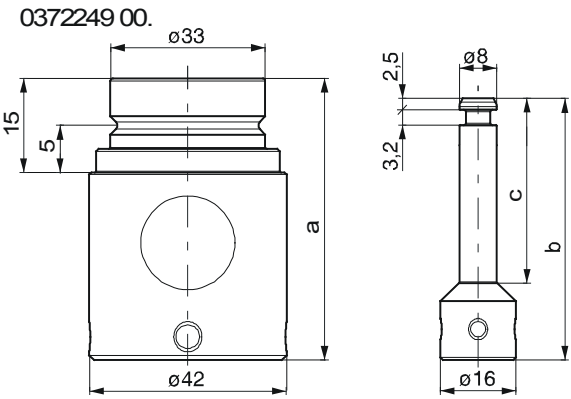

	a [mm]	b [mm]	c [mm]
0372249 001	60	55,8	40
0372249 002	80	75,8	60

Z10220

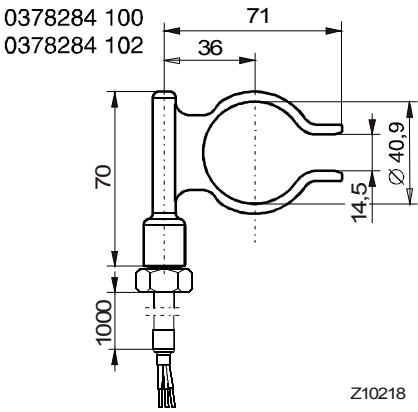

Z10218